

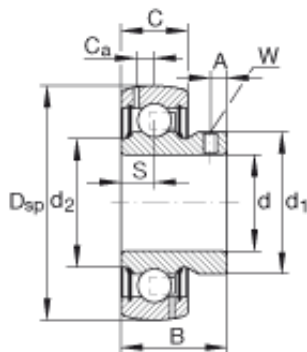

DEARING OF AMERICA CORP.



INA GAY008-NPP-B-AS2/V deep groove ball bearings

Bearing No. GAY008-NPP-B-AS2/V

Size	12.7000x40x22 mm
Bore Diameter	12,7000 mm
Outer Diameter	40 mm
Width	22 mm
d	1/2 inch
d	12,7000 mm
D _{SP}	40 mm
B	22 mm
A	0,157 inch
C	0,472 inch
C _a	0,134 inch
d ₁	0,941 inch
d ₂	0,902 inch
S	0,236 inch
W	3/32 inch
m	0,1 kg / Weight
C _r	10100 N / Dynamic load rating (radial)
Category	Insert Bearings Spherical OD
Inventory	0.0
Manufacturer Name	SCHAEFFLER GROUP
Minimum Buy Quantity	N/A
Weight / Kilogram	0.12
Product Group	M06110

GAY008-NPP-B-AS2/V Bearing 2D drawings and 3D CAD models



DEARING OF AMERICA CORP.

Inner Race Profile	Narrow Inner Ring
Outer Race Profile	Spherical
Relubricatable	Yes
Seal Type	Double Lip Contact
Mounting Method	Set Screw
Rolling Element	Ball Bearing
Snap Ring	No
Long Description	1/5" Bore; Narrow Inner Ring; Ball Bearing; 0.866" Length Thru Bore; 0.472" Outer Race Width; 1.575" Outside Diameter; Relubricatable; Double Lip Contact Seal; Set Screw Mounting M
Inch - Metric	Inch
Other Features	Single Row Grub Screw
Category	Insert Bearings
UNSPSC	31171536
Harmonized Tariff Code	8482.10.50.00
Noun	Bearing
Keyword String	Insert
Manufacturer URL	http://www.ina.com
Manufacturer Item Number	GAY008NPPB
Weight / LBS	0.221
Bore	0.5 Inch 12.7 Millimeter
Length Thru Bore	0.866 Inch 21.996 Millimeter
Outside Diameter	1.575 Inch 40.005 Millimeter
Outer Race Width	0.472 Inch 11.989 Millimeter